



# Norwegian Elkhound Club of the Potomac Valley

## August 3, 4 & 5, 2012 Judging Program

Fredericksburg Field House, 3411 Shannon Park Drive, Fredericksburg, VA 22408

**Please check your entry information for accuracy! (Especially your dog's AKC number and the classes entered!)**

If there are any errors, contact the Trial Secretary:

**Rhonda Toren** ♦ Phone: 410-997-3698 ♦ e-mail: [agilitysec@clantyre.net](mailto:agilitysec@clantyre.net)

**This judging program contains a LOT of new site information.  
PLEASE READ THOROUGHLY to avoid confusion over the weekend!**

**Armband Numbers and Check-In:** Armbands will be available at the check-in table (alphabetical by owner).

**Check-in for measuring:** Begins on Friday at 9:00 a.m., Saturday and Sunday at 7:15 a.m. Additional measuring time will be provided (as available) as courses are being set. If a measurement is necessary, it is the exhibitor's responsibility to have their dog(s) measured prior to running.

**Reminder:** All exhibitors should carry their dog's original AKC official Jump Height Card with them to each trial, in order to present the card upon request. **VMOs** will be present all three days. If you do not have a permanent height card, your dog **MUST** be measured for one.

**Move ups** for the August 3<sup>rd</sup> trial must be received by 6 p.m. on Monday, July 30. Day-to-day move-ups will be allowed and must be submitted within ½ hour of the end of judging each day. The move-up book will be located on the check-in table. Just fill out your move-up form and leave it in the book. Magically, your move-up will happen overnight. ☺

**We wish to thank all those who have volunteered to help at this trial!** The worker coordinator will be Jan Huff (e-mail: [agilelab@juno.com](mailto:agilelab@juno.com)). Workers willing to work 2 classes a day can make \$5.00 in CASH. If you want to make \$10.00, work 4 classes! ☺ Make sure your ring captain "stamps" your hand and see Betsy Flagg for payment.

Ring Captains:

Friday: Donna Richardson (STD) & Barbara Miller (JWW)  
Saturday: Susan Merchant (STD) & Barbara Miller (JWW)  
Sunday: Donna Richardson (STD) & Susan Merchant (JWW)

Please follow the link below to sign up to volunteer online wherever you like! We can't do it without you!

The link for the volunteer sign-up document is: <http://bit.ly/OkeJhP>

### **ACCOMMODATIONS:**

|                                                                                                                      |              |
|----------------------------------------------------------------------------------------------------------------------|--------------|
| Country Inn and Suites, 5327 Jefferson Davis Highway, Fredericksburg, VA 22401 -- Rt. I-95, Exit 126 (Southern exit) | 540-898-1800 |
| Best Western, 2205 Plank Road, Fredericksburg, VA 22401                                                              | 540-371-5050 |
| Best Western Central Plaza, 3000 Plank Road, Fredericksburg, VA 22401                                                | 540-786-7404 |

### **DIRECTIONS TO TRIAL SITE**

From **I-95:** Take exit 130 A to Fredericksburg/Route 3 East. Travel approximately 3 miles.

Take Route 2/17 South toward Bowling Green (Dixon Street).

Travel approximately 5 stoplights and turn **RIGHT** on Shannon Park Drive (WaWa on the corner). The Field House is the large warehouse style building at the end of the road.

From **Route 1:** Take Route 3 East. Travel approximately 1.5 miles.

Take Route 2/17 South toward Bowling Green (Dixon Street).

Travel approximately 5 stoplights and turn **RIGHT** on Shannon Park Drive (WaWa on the corner). The Field House is the large warehouse style building at the end of the road.

See <http://www.fredfieldhouse.com> for a map and additional information about the site.

**Don't forget to visit our vendors!** Mutts R Us (Sat only), Doug Phillips – Photographer (Fri only), Agility Track Forever (Sat only), Whiskazz and Pawzz, Peak Performance Dog Sports, EMB Monogramming, Anne Hennessey (Pet Massage) and Greg Paul DVM (Pet Massage and Therapy)

### **EMERGENCY NUMBERS**

**Veterinarian on Call:** Confederate Ridge Animal Hospital, 2301 Jefferson Davis Highway, Fredericksburg, VA 22401 **(540) 373-6100**

### **Directions to Emergency Clinic:**

**Fredericksburg Regional Veterinary Emergency Clinic**, 1301 Central Park Blvd., Fredericksburg, VA 22401 **(540) 372-3470**

Start out going Northeast on Shannon Park Dr. toward Tidewater Trl/US-17 BR/VA-2. Turn Left. Continue on US-17 BR North/VA-2 North.

Merge onto VA-3 W toward Culpepper. Turn Right on Central Park Blvd. #1301 is on the Right. Approximate travel: 10 minutes / 5.75 miles

**Fredericksburg Field House: (540) 361-4717 (Day-of-show emergency contact number)**

**Emergency Services:** Fire / Ambulance / Police

**Dial 911**

# Norwegian Elkhound Club of the Potomac Valley

August 3, 4 & 5, 2012

## SITE INFORMATION

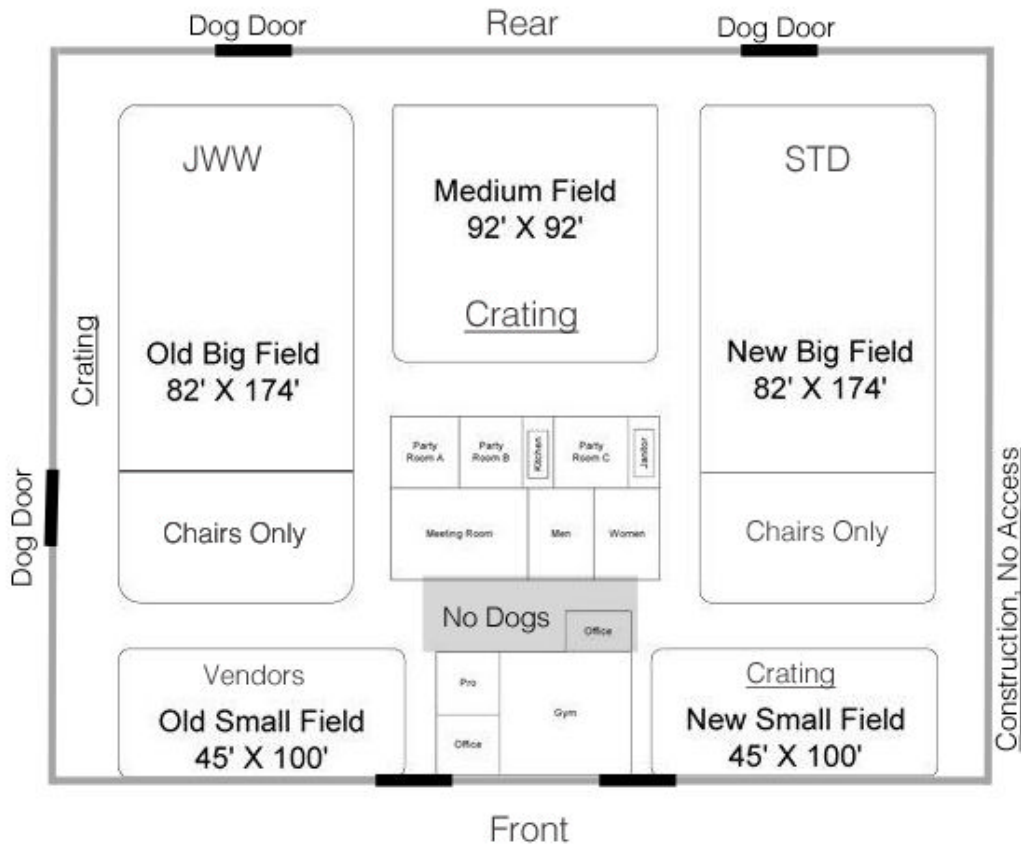

## IMPORTANT NOTES:

**Construction of an outdoor soccer field is ongoing.**

**Many parking places are blocked from our use due to the construction.**

**There are plenty of access doors for dogs through the rear, left side and front of the building.**

**Access through the construction area is strictly prohibited.**

**Crating/setup:** Setup will not be available on Thursday evening. The building will open at 8:00 a.m. on Friday for set-up. There will be **NO access to the building prior to 8:00 a.m.** for dogs OR people (except for trial officials/committee.)

Crate aggressive/reactive dogs must be covered and may not be positioned on the corners of aisles or entrances to the crating areas. This will be strictly enforced. If complaints are received, dogs will be moved. NO Flexi-leads are allowed indoors.

**Chairs ONLY (no crates!) in the Standard and JWW rings.** Crating areas will be in other field turf rings not used for competition. Please crate in marked areas only. All crates, ex-pens, etc. set up anywhere on field turf MUST have protective barrier underneath.

**Dogs will NOT be allowed** in the front row of seating closest to the ring gating or within 5 feet of the ring gating unless they are getting ready to enter the ring.

No food or drinks on playing field. (This rule has been relaxed for our agility trials. However, utmost care of the turf is a priority at all times.) No glass containers, chewing tobacco, chewing gum, sunflower seeds or similar products permitted in the facility.

Do **not** approach the field house staff regarding the indoor temperature.

**Food and refreshments** will be available at the trial site. **Dogs will not be allowed in the area in front of the food vendor!**

**REMEMBER! KEEP THE AREA CLEAN!** As always, exhibitors are responsible for cleaning up any deposits left by their dog. Do NOT allow dogs to eliminate on the shrubs anywhere against the building.

Any exhibitor failing to follow these rules will be EXCUSED without benefit of refund if the Show Committee deems the exhibitor is in violation of this requirement. Let's keep this beautiful site dog friendly! ☺

# Judging Schedule

Running Order as of July 24, 2012

(Preliminary running order, contingent upon move-up entries that may not have been received.)

The earliest possible time at which the first class's **briefing** followed by the first official **walk-through**:

**Friday - Ring 1:** 9:15 a.m. **Ring 2:** 9:45 a.m.

**Saturday & Sunday - Ring 1:** 7:45 a.m. **Ring 2:** 8:15 a.m.

## Walk-Throughs:

**Novice & Open (STD, JWW & FAST):** all walk together

**Excellent (STD and JWW):** 4/8", 12", 16", 20" walk/walk-run/run (split walk-through), 24/26"

**Time2Beat and Excellent FAST:** Walk-throughs at Judge's discretion

Lunch Break to be taken at Judge's discretion. Electronic Timers will be used in both rings.

Classes will be run concurrently (B, A, Preferred) within height divisions in the following order:

## Friday

◆Running order: Small to Tall◆

**Ring 1**  
**Judge: Cindy Elliott**

**Start time: 9:30 am**

**Ring 2**  
**Judge: Laura English**

**Start time: 10:00 am**

| Class | Level        | 4" | 8" | 12" | 16" | 20" | 24" | 26" | Total      |
|-------|--------------|----|----|-----|-----|-----|-----|-----|------------|
| FAST  | Novice       | 0  | 1  | 2   | 3   | 10  | 3   | 0   | 19         |
| FAST  | Open         | 1  | 2  | 3   | 1   | 10  | 2   | 0   | 19         |
| STD   | Excellent    | 3  | 38 | 42  | 38  | 68  | 25  | 1   | 215        |
| STD   | Open         | 0  | 0  | 2   | 3   | 9   | 4   | 0   | 18         |
| STD   | Novice       | 0  | 2  | 5   | 4   | 13  | 5   | 0   | 29         |
|       | <b>Total</b> |    |    |     |     |     |     |     | <b>300</b> |

| Class | Level        | 4" | 8" | 12" | 16" | 20" | 24" | 26" | Total      |
|-------|--------------|----|----|-----|-----|-----|-----|-----|------------|
| FAST  | Excellent    | 0  | 4  | 12  | 11  | 27  | 12  | 0   | 66         |
| JWW   | Novice       | 0  | 5  | 4   | 3   | 12  | 7   | 0   | 31         |
| JWW   | Open         | 0  | 1  | 2   | 1   | 10  | 0   | 0   | 14         |
| JWW   | Excellent    | 2  | 36 | 45  | 40  | 68  | 27  | 1   | 219        |
|       | <b>Total</b> |    |    |     |     |     |     |     | <b>330</b> |

## Saturday

◆Running order: Tall to Small◆

**Ring 1**  
**Judge: Laura English**

**Start time: 8:00 am**

**Ring 2**  
**Judge: Cindy Elliott**

**Start time: 8:30 am**

| Class | Level        | 26" | 24" | 20" | 16" | 12" | 8" | 4" | Total      |
|-------|--------------|-----|-----|-----|-----|-----|----|----|------------|
| STD   | Excellent    | 1   | 22  | 86  | 44  | 47  | 44 | 3  | 247        |
| STD   | Open         | 0   | 6   | 9   | 4   | 5   | 1  | 0  | 25         |
| STD   | Novice       | 0   | 5   | 10  | 9   | 5   | 3  | 0  | 32         |
|       | <b>Total</b> |     |     |     |     |     |    |    | <b>304</b> |

| Class | Level        | 26" | 24" | 20" | 16" | 12" | 8" | 4" | Total      |
|-------|--------------|-----|-----|-----|-----|-----|----|----|------------|
| JWW   | Novice       | 0   | 6   | 9   | 7   | 6   | 6  | 0  | 34         |
| JWW   | Open         | 0   | 4   | 15  | 1   | 3   | 1  | 0  | 24         |
| JWW   | Excellent    | 1   | 22  | 86  | 48  | 51  | 43 | 2  | 253        |
|       | <b>Total</b> |     |     |     |     |     |    |    | <b>311</b> |

## Sunday

◆Running order: Small to Tall◆

**Ring 1**  
**Judge: Cindy Elliott**

**Start time: 8:00 am**

**Ring 2**  
**Judge: Laura English**

**Start time: 8:30 am**

| Class | Level        | 4" | 8" | 12" | 16" | 20" | 24" | 26" | Total      |
|-------|--------------|----|----|-----|-----|-----|-----|-----|------------|
| STD   | Excellent    | 3  | 38 | 39  | 41  | 74  | 23  | 1   | 219        |
| STD   | Open         | 0  | 0  | 4   | 5   | 12  | 5   | 0   | 26         |
| STD   | Novice       | 0  | 5  | 7   | 9   | 5   | 1   | 0   | 27         |
|       | <b>Total</b> |    |    |     |     |     |     |     | <b>272</b> |

| Class | Level        | 4" | 8" | 12" | 16" | 20" | 24" | 26" | Total      |
|-------|--------------|----|----|-----|-----|-----|-----|-----|------------|
| JWW   | Novice       | 0  | 3  | 3   | 7   | 8   | 6   | 0   | 27         |
| JWW   | Open         | 0  | 0  | 4   | 2   | 15  | 3   | 0   | 24         |
| JWW   | Excellent    | 3  | 35 | 41  | 45  | 71  | 24  | 1   | 220        |
| T2B   |              | 0  | 10 | 13* | 17  | 32  | 12* | 0   | 84         |
|       | <b>Total</b> |    |    |     |     |     |     |     | <b>355</b> |

**\*Judge Change:** Cindy Elliott will be judging Time2Beat 12" & 24" Regular and Preferred. Exhibitors may request a full refund for any classes affected.

Please be on the line at least 4 dogs before your turn to go.

If you have a conflict, please make every effort to walk with an \*earlier\* group to insure the smooth running of the trial and timely results for each height division. Thank you!!

Enjoy!